

**Ball bearing units  
pillow block type  
UCP (with set screws)**

*d* 12 ~ (55) mm

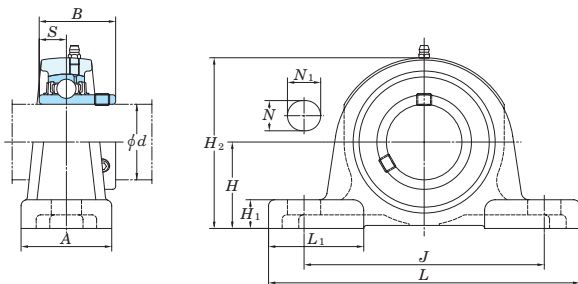

Pressed steel covers

Cast iron covers

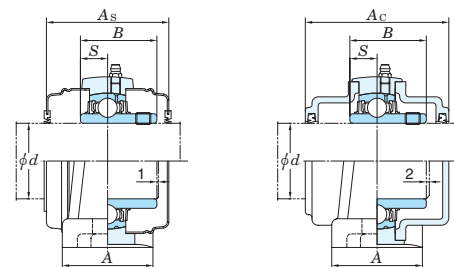

Tolerance for housing

| housing No.   |               |               | unit : mm    |
|---------------|---------------|---------------|--------------|
|               |               |               | $\Delta H_s$ |
| P203-<br>P210 | PX05-<br>PX10 | P305-<br>P310 | $\pm 0.15$   |
| P211-<br>P218 | PX11-<br>PX18 | P311-<br>P318 | $\pm 0.2$    |
|               | PX20          | P319-<br>P328 | $\pm 0.3$    |

$\Delta H_s$  : deviation of distance from mounting base to centre of spherical bearing seating.

P204JE3, P205JE3 (with cast iron covers) are shown below.

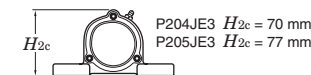

| Shaft dia.<br>(mm)<br><i>d</i> | Dimensions<br>(mm)   |                       |           |            |           |                      |                      |                      |                      |          |          | Bolt<br>size | Unit No. | Housing<br>No. | Applicable bearing |                            |       | Unit No. with covers           |                      |          |                  | Cover<br>dimensions<br>(mm)<br><i>A<sub>s</sub></i> <i>A<sub>c</sub></i> | (Refer.)<br>Unit mass (kg) |                     |      |      |      |
|--------------------------------|----------------------|-----------------------|-----------|------------|-----------|----------------------|----------------------|----------------------|----------------------|----------|----------|--------------|----------|----------------|--------------------|----------------------------|-------|--------------------------------|----------------------|----------|------------------|--|----------------------------|---------------------|------|------|------|
|                                | <i>H</i>             | <i>L</i>              | <i>A</i>  | <i>J</i>   | <i>N</i>  | <i>N<sub>1</sub></i> | <i>H<sub>1</sub></i> | <i>H<sub>2</sub></i> | <i>L<sub>1</sub></i> | <i>B</i> | <i>S</i> |              |          |                | No.                | Basic load ratings<br>(kN) |       | Factor<br><i>f<sub>0</sub></i> | Pressed steel covers |          | Cast iron covers |  | Pressed<br>steel covers    | Cast iron<br>covers |      |      |      |
|                                | <i>C<sub>r</sub></i> | <i>C<sub>0r</sub></i> | Open ends | Closed end | Open ends | Closed end           |                      |                      |                      |          |          |              |          |                |                    |                            |       |                                |                      |          |                  |  |                            |                     |      |      |      |
| 12                             | 30.2                 | 127                   | 38        | 95         | 13        | 18                   | 12                   | 60                   | 38                   | 31       | 12.7     | M10          | UCP201   | P203           | UC201              | 12.8                       | 6.65  | 13.2                           | UCP201C              | UCP201CD | —                | —  | 44                         | —                   | 0.63 | —    |      |
|                                | 15                   | 30.2                  | 127       | 38         | 95        | 13                   | 18                   | 12                   | 60                   | 38       | 31       | 12.7         | M10      | UCP202         | P203               | UC202                      | 12.8  | 6.65                           | 13.2                 | UCP202C  | UCP202CD         | —  | —                          | 44                  | —    | 0.61 | —    |
|                                |                      | 17                    | 30.2      | 127        | 38        | 95                   | 13                   | 18                   | 12                   | 60       | 38       | 31           | 12.7     | M10            | UCP203             | P203                       | UC203 | 12.8                           | 6.65                 | 13.2     | UCP203C          | UCP203CD   | —                          | —                   | 44   | —    | 0.60 |
| 20                             | 33.3                 | 127                   | 38        | 95         | 13        | 18                   | 13                   | 64                   | 38                   | 31       | 12.7     | M10          | UCP204   | P204           | UC204              | 12.8                       | 6.65  | 13.2                           | UCP204C              | UCP204CD | UCP204FC         | UCP204FCD  | 44                         | 62                  | 0.66 | 0.96 |      |
|                                | 25                   | 36.5                  | 140       | 38         | 105       | 13                   | 18                   | 13                   | 71                   | 43       | 14.3     | M10          | UCP205   | P205           | UC205              | 14.0                       | 7.85  | 13.9                           | UCP205C              | UCP205CD | UCP205FC         | UCP205FCD  | 48                         | 66                  | 0.80 | 1.2  |      |
|                                |                      | 44.4                  | 159       | 51         | 119       | 17                   | 25                   | 16                   | 86                   | 47       | 15.9     | M14          | UCPX05   | PX05           | UCX05              | 19.5                       | 11.3  | 13.9                           | UCPX05C              | UCPX05CD | —                | —  | 52                         | —                   | 1.5  | —    |      |
| 45                             | 175                  | 45                    | 132       | 17         | 20        | 16                   | 85                   | 55                   | 38                   | 15       | M14      | UCP305       | P305     | UC305          | 21.2               | 10.9                       | 12.6  | —                              | —                    | UCP305C  | UCP305CD         | —  | 76                         | 1.7                 | 2.3  |      |      |
| 30                             | 42.9                 | 165                   | 48        | 121        | 17        | 21                   | 15                   | 84                   | 53                   | 38.1     | 15.9     | M14          | UCP206   | P206           | UC206              | 19.5                       | 11.3  | 13.9                           | UCP206C              | UCP206CD | UCP206FC         | UCP206FCD  | 52                         | 70                  | 1.3  | 1.8  |      |
|                                | 47.6                 | 175                   | 57        | 127        | 17        | 25                   | 17                   | 93                   | 55                   | 42.9     | 17.5     | M14          | UCPX06   | PX06           | UCX06              | 25.7                       | 15.4  | 13.9                           | UCPX06C              | UCPX06CD | —                | —  | 59                         | —                   | 2.1  | —    |      |
|                                | 50                   | 180                   | 50        | 140        | 17        | 20                   | 17                   | 95                   | 53                   | 43       | 17       | M14          | UCP306   | P306           | UC306              | 26.7                       | 15.0  | 13.3                           | —                    | —        | UCP306C          | UCP306CD   | —                          | 82                  | 2.2  | 2.8  |      |
| 35                             | 47.6                 | 167                   | 48        | 127        | 17        | 21                   | 16                   | 93                   | 51                   | 42.9     | 17.5     | M14          | UCP207   | P207           | UC207              | 25.7                       | 15.4  | 13.9                           | UCP207C              | UCP207CD | UCP207FC         | UCP207FCD  | 59                         | 78                  | 1.6  | 2.3  |      |
|                                | 54                   | 203                   | 57        | 144        | 17        | 30                   | 19                   | 105                  | 64                   | 49.2     | 19       | M14          | UCPX07   | PX07           | UCX07              | 29.1                       | 17.8  | 14.0                           | UCPX07C              | UCPX07CD | —                | —  | 68                         | —                   | 2.7  | —    |      |
|                                | 56                   | 210                   | 56        | 160        | 17        | 25                   | 19                   | 107                  | 65                   | 48       | 19       | M14          | UCP307   | P307           | UC307              | 33.4                       | 19.3  | 13.2                           | —                    | —        | UCP307C          | UCP307CD   | —                          | 88                  | 3.0  | 3.8  |      |
| 40                             | 49.2                 | 184                   | 54        | 137        | 17        | 21                   | 17                   | 98                   | 57                   | 49.2     | 19       | M14          | UCP208   | P208           | UC208              | 29.1                       | 17.8  | 14.0                           | UCP208C              | UCP208CD | UCP208FC         | UCP208FCD  | 68                         | 86                  | 2.0  | 2.8  |      |
|                                | 58.7                 | 222                   | 67        | 156        | 20        | 32                   | 21                   | 114                  | 71                   | 49.2     | 19       | M16          | UCPX08   | PX08           | UCX08              | 32.7                       | 20.3  | 14.0                           | UCPX08C              | UCPX08CD | —                | —  | 68                         | —                   | 3.5  | —    |      |
|                                | 60                   | 220                   | 60        | 170        | 17        | 27                   | 19                   | 118                  | 65                   | 52       | 19       | M14          | UCP308   | P308           | UC308              | 40.7                       | 24.0  | 13.2                           | —                    | —        | UCP308C          | UCP308CD   | —                          | 96                  | 3.8  | 4.8  |      |
| 45                             | 54                   | 190                   | 54        | 146        | 17        | 21                   | 17                   | 106                  | 60                   | 49.2     | 19       | M14          | UCP209   | P209           | UC209              | 32.7                       | 20.3  | 14.0                           | UCP209C              | UCP209CD | UCP209FC         | UCP209FCD  | 68                         | 88                  | 2.2  | 3.0  |      |
|                                | 58.7                 | 222                   | 67        | 156        | 20        | 33                   | 21                   | 116                  | 71                   | 51.6     | 19       | M16          | UCPX09   | PX09           | UCX09              | 35.1                       | 23.3  | 14.4                           | UCPX09C              | UCPX09CD | —                | —  | 73                         | —                   | 3.7  | —    |      |
|                                | 67                   | 245                   | 67        | 190        | 20        | 30                   | 21                   | 132                  | 75                   | 57       | 22       | M16          | UCP309   | P309           | UC309              | 48.9                       | 29.5  | 13.3                           | —                    | —        | UCP309C          | UCP309CD   | —                          | 102                 | 4.9  | 6.2  |      |
| 50                             | 57.2                 | 206                   | 60        | 159        | 20        | 22                   | 19                   | 113                  | 63                   | 51.6     | 19       | M16          | UCP210   | P210           | UC210              | 35.1                       | 23.3  | 14.4                           | UCP210C              | UCP210CD | UCP210FC         | UCP210FCD  | 73                         | 97                  | 2.9  | 3.9  |      |
|                                | 63.5                 | 241                   | 73        | 171        | 20        | 36                   | 22                   | 126                  | 76                   | 55.6     | 22.2     | M16          | UCPX10   | PX10           | UCX10              | 43.4                       | 29.4  | 14.4                           | UCPX10C              | UCPX10CD | —                | —  | 75                         | —                   | 4.6  | —    |      |
|                                | 75                   | 275                   | 75        | 212        | 20        | 35                   | 24                   | 148                  | 88                   | 61       | 22       | M16          | UCP310   | P310           | UC310              | 62.0                       | 38.3  | 13.2                           | —                    | —        | UCP310C          | UCP310CD   | —                          | 110                 | 6.6  | 8.2  |      |
| 55                             | 63.5                 | 219                   | 60        | 171        | 20        | 22                   | 19                   | 125                  | 70                   | 55.6     | 22.2     | M16          | UCP211   | P211           | UC211              | 43.4                       | 29.4  | 14.4                           | UCP211C              | UCP211CD | UCP211FC         | UCP211FCD  | 75                         | 99                  | 3.6  | 4.8  |      |

[Remarks] 1) Applicable sizes of grease nipples are shown below.  
 A-1/4-28UNF ..... 201~210, X05~X09, 305~308  
 A-PT 1/8 ..... 211~218, X10~X20, 309~328

2) For bearings with double- or triple-lip seals, unit and bearing number are suffixed by L2 or L3.  
 3) For more detailed information, refer to ball bearing for unit specification tables.

**Ball bearing units  
pillow block type  
UCP (with set screws)**

*d* (55) ~ 95 mm

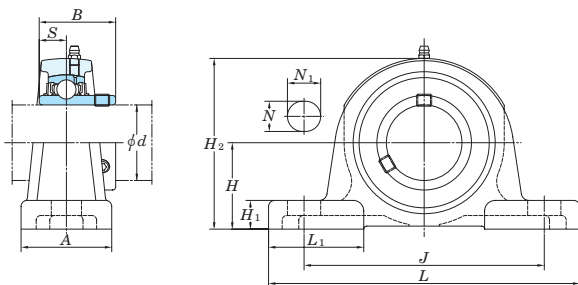

Pressed steel covers

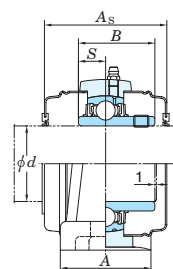

Cast iron covers

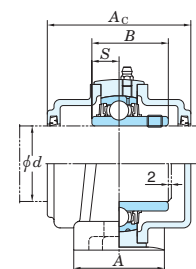

Tolerance for housing

| housing No.   |               |               | unit : mm<br>$\Delta H_s$ |
|---------------|---------------|---------------|---------------------------|
| P203-<br>P210 | PX05-<br>PX10 | P305-<br>P310 | $\pm 0.15$                |
| P211-<br>P218 | PX11-<br>PX18 | P311-<br>P318 | $\pm 0.2$                 |
|               | PX20          | P319-<br>P328 | $\pm 0.3$                 |

$\Delta H_s$  : deviation of distance from mounting base to centre of spherical bearing seating.

| Shaft dia.<br>(mm)<br><i>d</i> | Dimensions<br>(mm)   |                       |                       |           |            |                       |                       |                       |                       |          |          | Bolt size | Unit No.                   | Housing No.          | Applicable bearing      |                            |      | Unit No. with covers |         |                      |          | Cover dimensions<br>(mm) |     | (Refer.)<br>Unit mass (kg) |                       |                      |                  |
|--------------------------------|----------------------|-----------------------|-----------------------|-----------|------------|-----------------------|-----------------------|-----------------------|-----------------------|----------|----------|-----------|----------------------------|----------------------|-------------------------|----------------------------|------|----------------------|---------|----------------------|----------|--------------------------|-----|----------------------------|-----------------------|----------------------|------------------|
|                                | <i>H</i>             | <i>L</i>              | <i>A</i>              | <i>J</i>  | <i>N</i>   | <i>N</i> <sub>1</sub> | <i>H</i> <sub>1</sub> | <i>H</i> <sub>2</sub> | <i>L</i> <sub>1</sub> | <i>B</i> | <i>S</i> |           |                            |                      | No.                     | Basic load ratings<br>(kN) |      | Factor               |         | Pressed steel covers |          | Cast iron covers         |     | <i>A</i> <sub>s</sub>      | <i>A</i> <sub>c</sub> | Pressed steel covers | Cast iron covers |
|                                | <i>C<sub>r</sub></i> | <i>C<sub>0r</sub></i> | <i>f</i> <sub>0</sub> | Open ends | Closed end | Open ends             | Closed end            | <i>A</i> <sub>s</sub> | <i>A</i> <sub>c</sub> |          |          |           |                            |                      |                         |                            |      |                      |         |                      |          |                          |     |                            |                       |                      |                  |
| 55                             | 69.8                 | 260                   | 79                    | 184       | 25         | 36                    | 28                    | 139                   | 83                    | 65.1     | 25.4     | M20       | UCPX11<br>UCP311           | PX11<br>P311         | UCX11<br>UC311          | 52.4                       | 36.2 | 14.4                 | UCPX11C | UCPX11CD             | —        | —                        | 88  | —                          | 6.5                   | —                    |                  |
|                                | 80                   | 310                   | 80                    | 236       | 20         | 38                    | 27                    | 158                   | 90                    | 66       | 25       | M16       |                            |                      |                         | 71.6                       | 45.0 | 13.2                 | —       | —                    | UCP311C  | UCP311CD                 | —   | 114                        | 7.9                   | 9.7                  |                  |
| 60                             | 69.8                 | 241                   | 70                    | 184       | 20         | 25                    | 22                    | 138                   | 76                    | 65.1     | 25.4     | M16       | UCP212<br>UCPX12<br>UCP312 | P212<br>PX12<br>P312 | UC212<br>UCX12<br>UC312 | 52.4                       | 36.2 | 14.4                 | UCP212C | UCP212CD             | UCP212FC | UCP212FCD                | 88  | 114                        | 4.9                   | 6.4                  |                  |
|                                | 76.2                 | 286                   | 83                    | 203       | 25         | 40                    | 28                    | 152                   | 88                    | 65.1     | 25.4     | M20       |                            |                      |                         | 57.2                       | 40.1 | 14.4                 | UCPX12C | UCPX12CD             | —        | —                        | 88  | —                          | 7.7                   | —                    |                  |
|                                | 85                   | 330                   | 85                    | 250       | 25         | 38                    | 29                    | 167                   | 103                   | 71       | 26       | M20       |                            |                      |                         | 81.9                       | 52.2 | 13.2                 | —       | —                    | UCP312C  | UCP312CD                 | —   | 124                        | 9.5                   | 11.8                 |                  |
| 65                             | 76.2                 | 265                   | 70                    | 203       | 25         | 30                    | 25                    | 150                   | 78                    | 65.1     | 25.4     | M20       | UCP213<br>UCPX13<br>UCP313 | P213<br>PX13<br>P313 | UC213<br>UCX13<br>UC313 | 57.2                       | 40.1 | 14.4                 | UCP213C | UCP213CD             | UCP213FC | UCP213FCD                | 88  | 114                        | 5.9                   | 7.6                  |                  |
|                                | 76.2                 | 286                   | 83                    | 203       | 25         | 40                    | 28                    | 155                   | 88                    | 74.6     | 30.2     | M20       |                            |                      |                         | 62.2                       | 44.1 | 14.5                 | UCPX13C | UCPX13CD             | —        | —                        | 98  | —                          | 8.1                   | —                    |                  |
|                                | 90                   | 340                   | 90                    | 260       | 25         | 38                    | 32                    | 176                   | 110                   | 75       | 30       | M20       |                            |                      |                         | 92.7                       | 59.9 | 13.2                 | —       | —                    | UCP313C  | UCP313CD                 | —   | 122                        | 10.7                  | 12.8                 |                  |
| 70                             | 79.4                 | 266                   | 72                    | 210       | 25         | 30                    | 28                    | 156                   | 78                    | 74.6     | 30.2     | M20       | UCP214<br>UCPX14<br>UCP314 | P214<br>PX14<br>P314 | UC214<br>UCX14<br>UC314 | 62.2                       | 44.1 | 14.5                 | UCP214C | UCP214CD             | UCP214FC | UCP214FCD                | 98  | 124                        | 6.8                   | 8.7                  |                  |
|                                | 88.9                 | 330                   | 89                    | 229       | 27         | 50                    | 32                    | 171                   | 98                    | 77.8     | 33.3     | M22       |                            |                      |                         | 67.4                       | 48.3 | 14.5                 | UCPX14C | UCPX14CD             | —        | —                        | 98  | —                          | 10.2                  | —                    |                  |
|                                | 95                   | 360                   | 90                    | 280       | 27         | 40                    | 35                    | 186                   | 110                   | 78       | 33       | M22       |                            |                      |                         | 104                        | 68.2 | 13.2                 | —       | —                    | UCP314C  | UCP314CD                 | —   | 124                        | 12.4                  | 14.7                 |                  |
| 75                             | 82.6                 | 275                   | 74                    | 217       | 25         | 30                    | 28                    | 162                   | 80                    | 77.8     | 33.3     | M20       | UCP215<br>UCPX15<br>UCP315 | P215<br>PX15<br>P315 | UC215<br>UCX15<br>UC315 | 67.4                       | 48.3 | 14.5                 | UCP215C | UCP215CD             | UCP215FC | UCP215FCD                | 98  | 124                        | 7.4                   | 9.3                  |                  |
|                                | 88.9                 | 330                   | 89                    | 229       | 27         | 50                    | 32                    | 175                   | 99                    | 82.6     | 33.3     | M22       |                            |                      |                         | 72.7                       | 53.0 | 14.6                 | UCPX15C | UCPX15CD             | —        | —                        | 108 | —                          | 10.8                  | —                    |                  |
|                                | 100                  | 380                   | 100                   | 290       | 27         | 40                    | 35                    | 198                   | 107                   | 82       | 32       | M22       |                            |                      |                         | 113                        | 77.2 | 13.2                 | —       | —                    | UCP315C  | UCP315CD                 | —   | 134                        | 14.8                  | 17.3                 |                  |
| 80                             | 88.9                 | 292                   | 78                    | 232       | 25         | 35                    | 32                    | 174                   | 86                    | 82.6     | 33.3     | M20       | UCP216<br>UCPX16<br>UCP316 | P216<br>PX16<br>P316 | UC216<br>UCX16<br>UC316 | 72.7                       | 53.0 | 14.6                 | UCP216C | UCP216CD             | UCP216FC | UCP216FCD                | 108 | 138                        | 9.0                   | 11.4                 |                  |
|                                | 101.6                | 381                   | 102                   | 283       | 27         | 58                    | 34                    | 195                   | 116                   | 85.7     | 34.1     | M22       |                            |                      |                         | 84.0                       | 61.9 | 14.5                 | UCPX16C | UCPX16CD             | —        | —                        | 112 | —                          | 15.3                  | —                    |                  |
|                                | 106                  | 400                   | 110                   | 300       | 27         | 40                    | 35                    | 209                   | 120                   | 86       | 34       | M22       |                            |                      |                         | 123                        | 86.7 | 13.3                 | —       | —                    | UCP316C  | UCP316CD                 | —   | 138                        | 18.5                  | 21.4                 |                  |
| 85                             | 95.2                 | 310                   | 83                    | 247       | 25         | 40                    | 32                    | 185                   | 90                    | 85.7     | 34.1     | M20       | UCP217<br>UCPX17<br>UCP317 | P217<br>PX17<br>P317 | UC217<br>UCX17<br>UC317 | 84.0                       | 61.9 | 14.5                 | UCP217C | UCP217CD             | UCP217FC | UCP217FCD                | 112 | 142                        | 10.8                  | 13.5                 |                  |
|                                | 101.6                | 381                   | 102                   | 283       | 27         | 60                    | 34                    | 200                   | 116                   | 96       | 39.7     | M22       |                            |                      |                         | 96.1                       | 71.5 | 14.5                 | UCPX17C | UCPX17CD             | —        | —                        | 122 | —                          | 16.1                  | —                    |                  |
|                                | 112                  | 420                   | 110                   | 320       | 33         | 45                    | 40                    | 220                   | 120                   | 96       | 40       | M27       |                            |                      |                         | 133                        | 96.8 | 13.3                 | —       | —                    | UCP317C  | UCP317CD                 | —   | 146                        | 20.3                  | 23.6                 |                  |
| 90                             | 101.6                | 327                   | 88                    | 262       | 27         | 45                    | 34                    | 198                   | 104                   | 96       | 39.7     | M22       | UCP218<br>UCPX18<br>UCP318 | P218<br>PX18<br>P318 | UC218<br>UCX18<br>UC318 | 96.1                       | 71.5 | 14.5                 | UCP218C | UCP218CD             | UCP218FC | UCP218FCD                | 122 | 152                        | 13.9                  | 17.0                 |                  |
|                                | 101.6                | 381                   | 111                   | 283       | 27         | 60                    | 38                    | 204                   | 116                   | 104      | 42.9     | M22       |                            |                      |                         | 109                        | 81.9 | 14.4                 | —       | —                    | UCPX18C  | UCPX18CD                 | —   | 158                        | 19.1                  | 22.5                 |                  |
|                                | 118                  | 430                   | 110                   | 330       | 33         | 45                    | 40                    | 234                   | 120                   | 96       | 40       | M27       |                            |                      |                         | 143                        | 107  | 13.3                 | —       | —                    | UCP318C  | UCP318CD                 | —   | 150                        | 22.8                  | 26.6                 |                  |
| 95                             | 125                  | 470                   | 120                   | 360       | 36         | 50                    | 46                    | 248                   | 125                   | 103      | 41       | M30       | UCP319                     | P319                 | UC319                   | 153                        | 119  | 13.3                 | —       | —                    | UCP319C  | UCP319CD                 | —   | 162                        | 29.0                  | 33.3                 |                  |

(Remarks) 1) Applicable sizes of grease nipples are shown below.  
A-1/4-28UNF ..... 201~210, X05~X09, 305~308  
A-PT 1/8 ..... 211~218, X10~X20, 309~328

2) For bearings with double- or triple-lip seals, unit and bearing number are suffixed by L2 or L3.  
3) For more detailed information, refer to ball bearing for unit specification tables.

**Ball bearing units  
pillow block type  
UCP (with set screws)**

*d* 100 ~ 140 mm

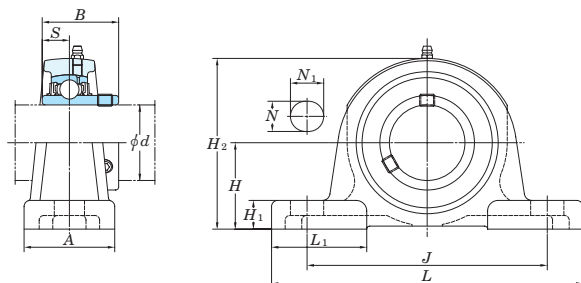

Pressed steel covers

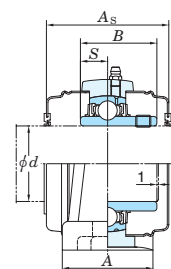

Cast iron covers

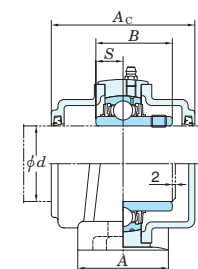

Tolerance for housing

unit : mm

| housing No.   |               |               | $\Delta H_s$ |
|---------------|---------------|---------------|--------------|
| P203-<br>P210 | PX05-<br>PX10 | P305-<br>P310 | $\pm 0.15$   |
| P211-<br>P218 | PX11-<br>PX18 | P311-<br>P318 | $\pm 0.2$    |
|               | PX20          | P319-<br>P328 | $\pm 0.3$    |

$\Delta H_s$  : deviation of distance from mounting base to centre of spherical bearing seating.

| Shaft dia.<br>(mm)<br><i>d</i> | Dimensions<br>(mm)   |                        |                       |           |            |                       |                       |                       |                       |              |          | Bolt<br>size | Unit No.      | Housing<br>No. | Applicable bearing |                            |     | Unit No. with covers |                      |   |                  | Cover<br>dimensions<br>(mm) |                       | (Refer.)<br>Unit mass (kg) |                         |                     |
|--------------------------------|----------------------|------------------------|-----------------------|-----------|------------|-----------------------|-----------------------|-----------------------|-----------------------|--------------|----------|--------------|---------------|----------------|--------------------|----------------------------|-----|----------------------|----------------------|---|------------------|-----------------------------|-----------------------|----------------------------|-------------------------|---------------------|
|                                | <i>H</i>             | <i>L</i>               | <i>A</i>              | <i>J</i>  | <i>N</i>   | <i>N</i> <sub>1</sub> | <i>H</i> <sub>1</sub> | <i>H</i> <sub>2</sub> | <i>L</i> <sub>1</sub> | <i>B</i>     | <i>S</i> |              |               |                | No.                | Basic load ratings<br>(kN) |     | Factor               | Pressed steel covers |   | Cast iron covers |                             | <i>A</i> <sub>s</sub> | <i>A</i> <sub>c</sub>      | Pressed<br>steel covers | Cast iron<br>covers |
|                                | <i>C<sub>r</sub></i> | <i>C</i> <sub>0r</sub> | <i>f</i> <sub>0</sub> | Open ends | Closed end | Open ends             | Closed end            | <i>A</i> <sub>s</sub> | <i>A</i> <sub>c</sub> | steel covers | covers   |              |               |                |                    |                            |     |                      |                      |   |                  |                             |                       |                            |                         |                     |
| <b>100</b>                     | 127                  | 432                    | 121                   | 337       | 33         | 65                    | 45                    | 245                   | 126                   | 117.5        | 49.2     | M27          | <b>UCPX20</b> | PX20           | UCX20              | 133                        | 105 | 14.4                 | —                    | — | UCPX20C          | UCPX20CD                    | —                     | 186                        | 30.4                    | 34.9                |
|                                | 140                  | 490                    | 120                   | 380       | 36         | 50                    | 46                    | 273                   | 140                   | 108          | 42       | M30          | <b>UCP320</b> | P320           | UC320              | 173                        | 141 | 13.2                 | —                    | — | UCP320C          | UCP320CD                    | —                     | 174                        | 35.1                    | 40.7                |
| <b>105</b>                     | 140                  | 490                    | 120                   | 380       | 36         | 50                    | 46                    | 278                   | 140                   | 112          | 44       | M30          | <b>UCP321</b> | P321           | UC321              | 184                        | 153 | 13.2                 | —                    | — | UCP321C          | UCP321CD                    | —                     | 178                        | 37.6                    | 43.6                |
| <b>110</b>                     | 150                  | 520                    | 140                   | 400       | 40         | 55                    | 50                    | 296                   | 150                   | 117          | 46       | M33          | <b>UCP322</b> | P322           | UC322              | 205                        | 180 | 13.2                 | —                    | — | UCP322C          | UCP322CD                    | —                     | 188                        | 44.0                    | 50.8                |
| <b>120</b>                     | 160                  | 570                    | 140                   | 450       | 40         | 55                    | 50                    | 316                   | 160                   | 126          | 51       | M33          | <b>UCP324</b> | P324           | UC324              | 207                        | 185 | 13.5                 | —                    | — | UCP324C          | UCP324CD                    | —                     | 196                        | 55.4                    | 64.9                |
| <b>130</b>                     | 180                  | 600                    | 140                   | 480       | 40         | 55                    | 50                    | 355                   | 195                   | 135          | 54       | M33          | <b>UCP326</b> | P326           | UC326              | 229                        | 214 | 13.6                 | —                    | — | UCP326C          | UCP326CD                    | —                     | 214                        | 72.1                    | 84.2                |
| <b>140</b>                     | 200                  | 620                    | 140                   | 500       | 40         | 55                    | 60                    | 393                   | 185                   | 145          | 59       | M33          | <b>UCP328</b> | P328           | UC328              | 253                        | 246 | 13.6                 | —                    | — | UCP328C          | UCP328CD                    | —                     | 222                        | 92.5                    | 108                 |

[Remarks] 1) Applicable sizes of grease nipples are shown below.  
 A-1/4-28UNF ..... 201~210, X05~X09, 305~308  
 A-PT 1/8 ..... 211~218, X10~X20, 309~328

2) For bearings with double- or triple-lip seals, unit and bearing number are suffixed by L2 or L3.  
 3) For more detailed information, refer to ball bearing for unit specification tables.